

Frame extension elements for fire protection windows EI 30

Product description

The Frinorm fire protection window frame extension elements are applicable with fire protection requirements up to EI 30. They are available with cement-bonded chipboard, untreated, or cement-bonded chipboard with real wood veneer. Rock wool, 30 kg/m³, is used for thermal insulation. The window frame extension elements are fabricated with a circumferential oak edge band. Special edge bands can be inset according to your requirements. All possible CNC edge profile work is performed on all sides according to your profile specifications.

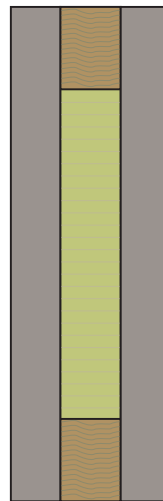
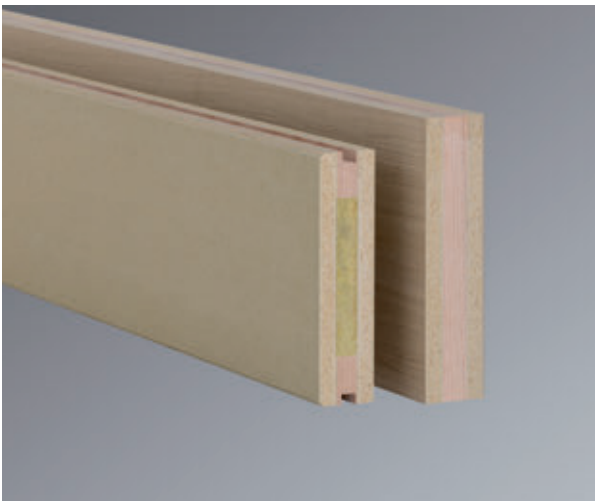

Range and design

Type	Cover panel and surface	Thermal insulation	Edge band	U-values
Untreated	Both sides 18 mm, cement-bonded chipboard, untreated	Rock wool, 30 kg/m ³	Oak, circumferential	Thermal transmittance coefficients up to 0.4 W/m ² K (For U-values, see table on technical data sheet)
Veneered	Both sides 18 mm, cement-bonded chipboard, covered with 1 mm real wood veneer; all types of real wood veneer available: spruce, pine, larch, fir, oak, etc.; veneer quality A/B (inside A/outside B) or A/A (inside A/outside A)		(Special edge bands are inset according to your requirements)	

Thicknesses

Thicknesses from 54 mm to 112 mm can be produced

Formats

All formats from 545 × 95 mm up to 3088 × 1244 mm can be manufactured

CNC edge milling

All possible CNC edge profile work is performed on all sides according to your profile specifications.

Consultation

For more information please refer to the technical data sheets.
Our technical consultants are at your service for all questions.

Frinorm AG, Wärmedämmelemente

Föhrenweg 9, FL-9496 Balzers, phone 00423 384 23 66, fax 00423 384 23 35, www.frinorm.com, info@frinorm.com