

## Frame extension elements for plastic windows

### Sound insulation

#### Product description

The Frinorm sound insulation window frame extension elements are the right choice, especially when high levels of sound and thermal insulation are required. They are available in hard PVC in different shades of white (Veka, Kömmerling or Finstral) or HPL with decorative foil (all colours). Depending on the sound insulation requirements, the frame extension elements are fabricated with heavy bitumen foil. Glass wool, 70 kg/m<sup>3</sup>, is used for thermal insulation. The frame extension elements are fabricated with a circumferential plywood edge band. Special edge bands are inset according to your requirements. All possible CNC edge profile work is performed on all sides according to your profile specifications. Special CNC processing, such as cut-outs and round and segment arches, and surface finishing, such as ventilation slots or surface grooves, are also possible.

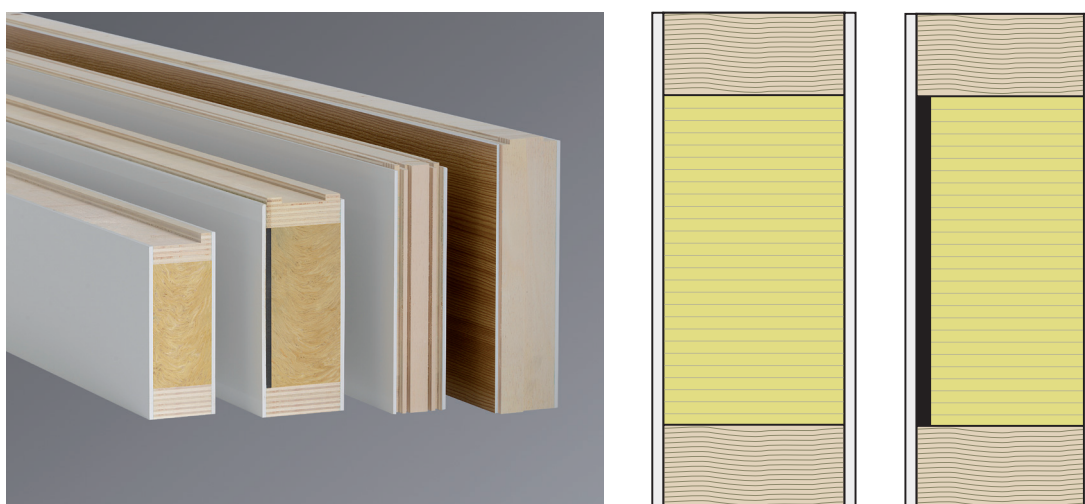

#### Range and design

Type	Cover panel and surface	Thermal and sound insulation	Edge band	U-values	dB-values
PVC, white	Both sides 4 mm, hard PVC, colour: Veka, Kömmerling or Finstral	Glass wool, 70 kg/m <sup>3</sup>  <b>Sound insulation 1:</b> without heavy bitumen foil	Plywood IW67, circumferential	Thermal transmittance coefficients up to 0.3 W/m <sup>2</sup> K  (For U-values, see table on technical data sheet)	<b>Airborne sound insulation values of up to 44 dB</b>  (For dB-values, see table on technical data sheet or on download of test reports)
HPL, decorative foil	Both sides 4 mm, HPL, coated with decorative foil; all colours available	<b>Sound insulation 2:</b> 1 piece of heavy bitumen foil			

#### Thicknesses

Thicknesses from 40 to 112 mm can be produced.

For thicknesses of 113 mm and more, see frame extension elements for plastic lifting sliding doors.

For thicknesses below 40 mm, see infill for plastic windows.

**Formats**

Hard PVC, white: all formats from 500 × 95 mm up to 3588 × 1294 mm can be manufactured.

HPL, decorative foil: all formats from 500 × 95 mm up to 2988 × 1294 mm can be manufactured.

**CNC edge milling**

All possible CNC edge profile work is performed on all sides according to your profile specifications. Special CNC processing, such as cut-outs and round and segment arches, and surface finishing, such as ventilation slots or surface grooves, are also possible.

**Consultation**

For more information please refer to the technical data sheets.

Our technical consultants are at your service for all questions.