

Frame extension elements for wooden and wood-metal windows
Moisture-resistant and with sound insulation

Product description

The moisture-resistant Frinorm sound insulation frame extension elements are the right choice especially for high demands on moisture resistance as well as high demands on thermal insulation. They are available with plywood board AW100, untreated, plywood board AW100, with primer foil, or plywood board AW100 with real wood veneer in all types of wood. Depending on the sound insulation requirements, the frame extension elements are fabricated with one or two heavy bitumen foils. Glass wool, 20 kg/m³, is used for thermal insulation. The window frame extension elements are fabricated with a circumferential spruce edge band. Special edge bands can be inset according to your requirements. All possible CNC edge profile work is performed on all sides according to your profile specifications. Special CNC processing like cut-outs, round and segment arches or surface finishing like ventilation slots or surface grooves are also possible.

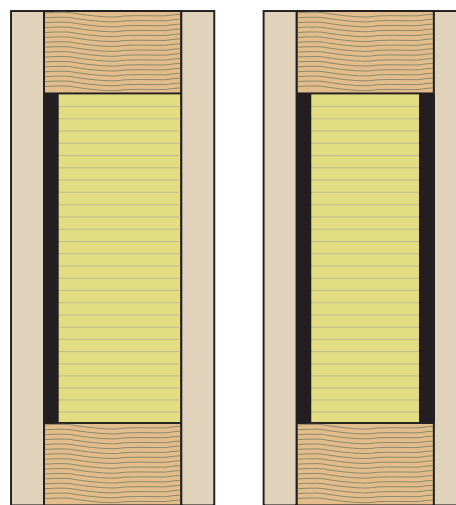

Range and design

Type	Cover panel and surface	Thermal insulation	Edge band	U-values	dB-values
Untreated	Both sides 12 mm, plywood board AW100, untreated	Glass wool, 20 kg/m ³ Sound insulation 1: 1 piece of heavy bitumen foil Sound insulation 2: 2 pieces of heavy bitumen foil	Spruce, circumferential (Other types of wood are also available; special edge bands are inset according to your requirements)	Thermal transmittance coefficients up to 0.3 W/m ² K (For U-values, see table on technical data sheet)	Airborne sound insulation values of up to 40 dB (For dB-values, see table on technical data sheet or on download of test reports)
Primerfoil	Both sides 9 mm, plywood board AW100, with primer foil				
Veneered	Both sides 12 mm, plywood board AW100, covered with 1 mm real wood veneer; available in all types of wood: spruce, pine, larch, fir, oak, etc.; veneer quality A/B (inside A/ outside B) or A/A (inside A/outside A)				

Thicknesses

Thicknesses from 44 mm to 112 mm can be produced

For thicknesses as from 113 mm, see expansion elements for wooden and wood-metal lifting sliding doors

For thicknesses below 44 mm, see infill for wooden and wood-metal windows

Formats

Plywood board, untreated and plywood board, with real wood veneer: all formats from 500 × 95 mm up to 3088 × 1294 mm can be manufactured.

Plywood board, with primer foil: all formats from 500 × 95 mm up to 2988 × 1294 mm can be manufactured.

CNC edge milling

All possible CNC edge profile work is performed on all sides according to your profile specifications. Special CNC processing like cut-outs, round and segment arches or surface finishing like ventilation slots or surface grooves are also possible.

Consultation

For more information please refer to the technical data sheets.

Our technical consultants are at your service for all questions.