

Iso panel

Application

The Frinorm Iso panel is suited for installation on ceilings and walls in residential rooms in new and converted buildings as well as in old-building renovation. It can be applied in single and multi-family houses as well as in commercial and public buildings.

Properties

- Thermal insulation and cladding in one step
- Excellent thermal insulation values of up to 0.45 W/m²K
- Two types of thermal insulation: with expanded rigid polystyrene foam (EPS) or with rock wool
- Real wood veneers in all types of wood
- Untreated (sanded or sawn), oiled, lacquered or glazed
- With or without shadow join
- With or without bevelled edge
- Dimensionally stable and non-warping
- No thermal bridges, perfect panel joins
- Optically attractive and appealing surface
- Uncomplicated and fast installation

Product description

The Frinorm Iso panel not only ensures outstanding thermal insulation but is also an absolutely non-warping, optically very appealing panel. All types of wood are available for selection of the desired real wood veneer surface. A durable and optically unchanged wall and ceiling cladding is guaranteed. The Iso panel is available with two different types of thermal insulation: expanded rigid polystyrene foam (EPS), 20 kg/m³, or rock wool, 160 kg/m³.

Both panels are covered with a 5 mm thick MDF board on both sides. The real wood veneer surface is available in all types of wood, untreated (sanded or sawn), lacquered, oiled or glazed, as well as with or without shadow join or bevelled edge.

Materials

Cover panel: MDF board, 5 mm

Surface: real wood veneer, 1 mm, available in all types of wood

Thermal insulation: expanded rigid polystyrene foam (EPS), 20 kg/m³, or rock wool, 160 kg/m³, 20–70 mm

Bonding: water-resistant D3 (EN 204-D3)

Surface

- Real wood veneer, inside: A-quality, 1 mm
- Real wood veneer, outside: B-quality, 1 mm (as stabiliser)
- Untreated (sanded or sawn), oiled, lacquered or glazed
- With or without shadow join (dimension freely selectable)
- With or without bevelled edge (dimension freely selectable)

Edge milling

- Circumferential groove and tongue joint
- With or without shadow join (dimension freely selectable)
- With or without bevelled edge (dimension freely selectable)

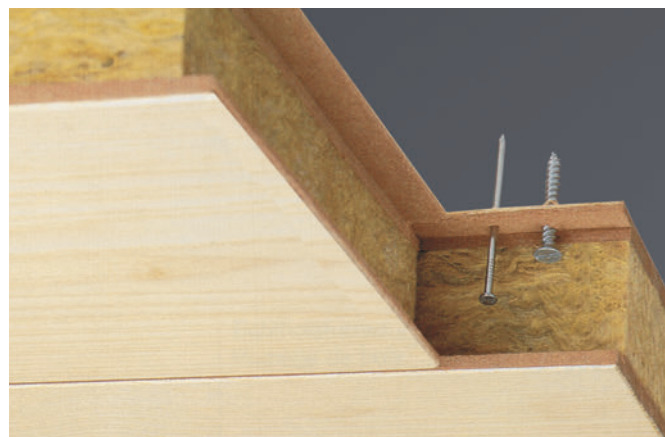
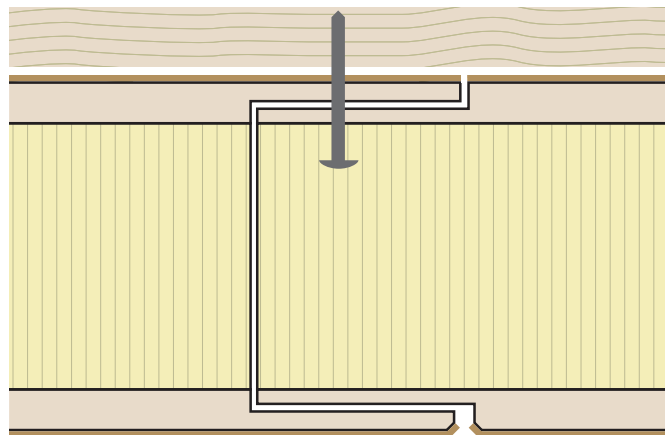

Dimensions

Usable format: 2050 × 190 mm (0.389 m²) or 2770 × 190 mm (0.526 m²)

Thicknesses: 32, 42, 52, 62, 72, 82 mm

Thermal transmittance coefficients (U-values)

Element thickness	mm	32	42	52	62	72	82
U-value (rigid polystyrene foam)	W/m ² K	1.232	0.918	0.732	0.608	0.520	0.455
U-value (rock wool)	W/m ² K	1.429	1.083	0.873	0.732	0.629	0.552

Delivery

Delivery of exact quantity on single-use pallets wrapped with stretch film

Consultation

For more information please refer to the technical data sheets.

Our technical consultants are at your service for all questions.

