

Plinth elements for plastic lifting sliding doors

Product description

Frinorm plinth elements for plastic lifting sliding doors for floors are especially suited for a wide range of demands, such as thermal protection and a high load capacity. They are available with a plywood board IW67, covered with unplasticised PVC. Intensely expanded rigid polystyrene foam (EPS perimeter), 30 kg/m³, is used for thermal insulation. All possible CNC edge profile work is performed on all sides according to your profile specifications

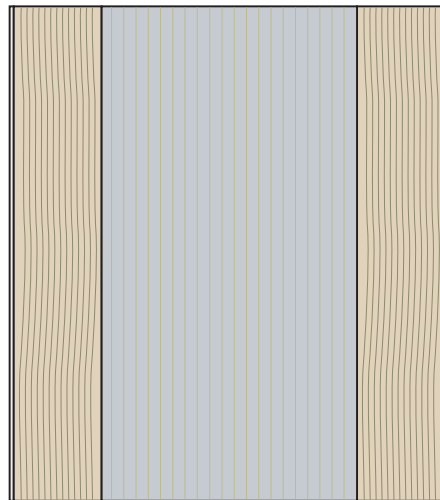
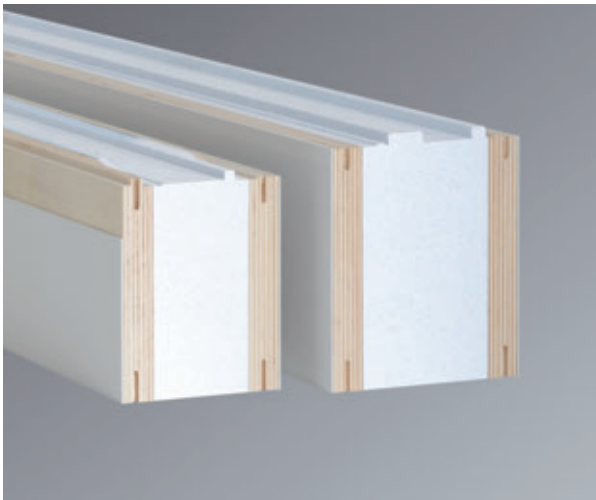

Range and design

| Type | Cover panel and surface | Thermal insulation | U-values |
|------------|--|---|--|
| PVC, white | Both sides 32 mm, plywood board IW67, covered with unplasticised PVC, 1.5 mm | Intensely expanded rigid polystyrene foam (EPS perimeter), 30 kg/m ³ | Thermal transmittance coefficients up to 0.1 W/m ² K (For U-values, see table on technical data sheet) |

Thicknesses

Thicknesses from 100 mm to 240 mm can be produced
For thicknesses below 100 mm, see plinth elements for plastic balcony doors

Formats

All formats from 500 × 95 mm up to 2510 × 1294 mm can be manufactured
Plinth elements that are longer than 2510 mm are shaped with grooves for dovetail joints

CNC edge milling

All possible CNC edge profile work is performed on all sides according to your profile specifications.

Consultation

For more information please refer to the technical data sheets. Our technical consultants are at your service for all questions.

Frinorm AG, Wärmedämmelemente

Föhrenweg 9, FL-9496 Balzers, phone 00423 384 23 66, fax 00423 384 23 35, www.frinorm.com, info@frinorm.com