

Plinth elements for wooden and wood-metal lifting sliding doors

Product description

Frinorm plinth elements for wooden and wood-metal lifting sliding doors for floors are especially suited for a wide range of demands, such as thermal protection and a high load capacity. Available with a mildew- and rot-resistant polyurethane board or a plywood board IW67. Intensely expanded rigid polystyrene foam (EPS perimeter), 30 kg/m³, is used for thermal insulation. All possible CNC edge profile work is performed on all sides according to your profile specifications.

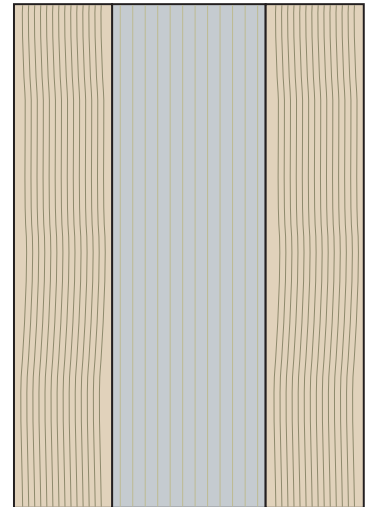
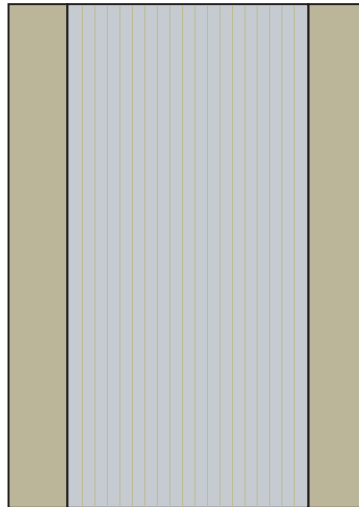
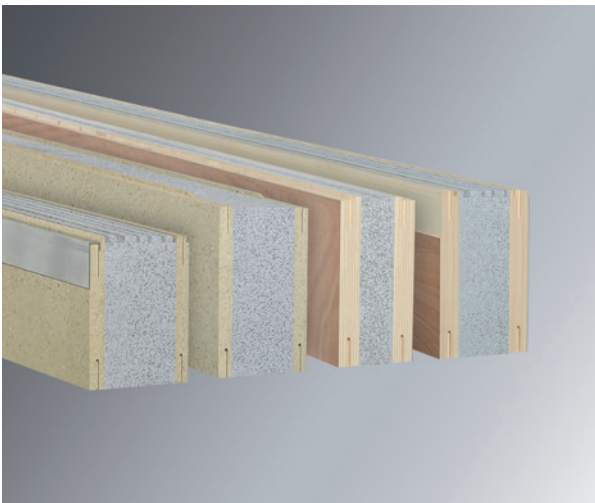

Range and design

Type	Cover panel and surface	Thermal insulation	U-values
Polyurethane	Both sides 26 mm, polyurethane board, mildew- and rot-resistant	Intensely expanded rigid polystyrene foam (EPS perimeter), 30 kg/m ³	Thermal transmittance coefficients up to 0.1 W/m ² K
Plywood	Both sides 40 mm, plywood board IW67		(For U-values, see table on technical data sheet)

Thicknesses

Thicknesses from 100 mm to 240 mm can be produced.
For thicknesses below 100 mm, see plinth elements for balcony doors.

Formats

Polyurethane: all formats from 500 × 95 mm to 3588 × 1294 mm can be produced.
Plywood: all formats from 500 × 95 mm to 2510 × 1294 mm can be produced.
Plinth elements that are longer than 2510 mm or 3588 mm are shaped with grooves for dovetail joints.

CNC edge milling

All possible CNC edge profile work is performed on all sides according to your profile specifications.

Consultation

For more information please refer to the technical data sheets.
Our technical consultants are at your service for all questions.

Frinorm AG, Wärmedämmelemente

Föhrenweg 9, FL-9496 Balzers, phone 00423 384 23 66, fax 00423 384 23 35, www.frinorm.com, info@frinorm.com