

Substructure elements for plastic balcony doors

Product description

Frinorm plinth elements for plastic balcony doors for floors are especially suited for a wide range of demands, such as thermal protection and a high load capacity. They are available with a plywood panel IW67, covered with rigid PVC, or with a 10 mm integral foam board made of rigid PVC. Intensely expanded polystyrene rigid foam (EPS perimeter), 30 kg/m³, is used for thermal insulation. All possible CNC edge profile work is performed on all sides according to your profile specifications.

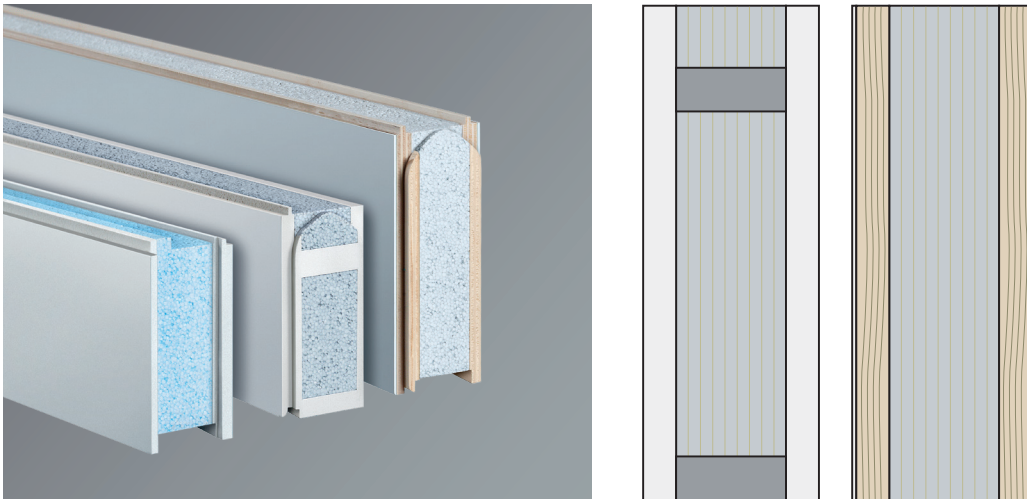

Range and design

Type	Cover panel and surface	Thermal insulation	U-values
PVC, white	Both sides 12 mm, plywood panel IW67, covered with rigid PVC, 1.5 mm	Intensely expanded polystyrene rigid foam (EPS perimeter), 30 kg/m ³	Thermal transmittance coefficients up to 0.3 W/m ² K
Integral foam board	Integral foam board made of rigid PVC, 10 mm		(For U-values, see table on technical data sheet)

Thicknesses

Thicknesses from 40 to 99 mm can be produced.

For thicknesses from 100 mm, see substructure elements for plastic lifting sliding doors.

Formats

Integral foam board: 500 × 95 mm to 2988 × 1294 mm

Plywood/PVC: 500 × 95 to 3088 × 994 mm

CNC edge milling

All possible CNC edge profile work is performed on all sides according to your profile specifications.

Consultation

For more information please refer to the technical data sheets. Our technical consultants are at your service for all questions.

Frinorm AG, Wärmedämmelemente

Föhrenweg 12, FL-9496 Balzers, phone 00423 384 23 66, fax 00423 384 23 35, www.frinorm.com, info@frinorm.com