

## Substructure elements for plastic lifting sliding doors

### Product description

The rot-resistant Frinorm substructure elements for plastic lifting sliding doors for floors are especially suited for a wide range of demands, such as thermal protection and a high load capacity. They are available with an integral foam board made of rigid PVC or with a polyurethane board. Intensely expanded polystyrene rigid foam (EPS perimeter), 30 kg/m<sup>3</sup>, is used for thermal insulation. All possible CNC edge profile work is performed according to your threshold profile.

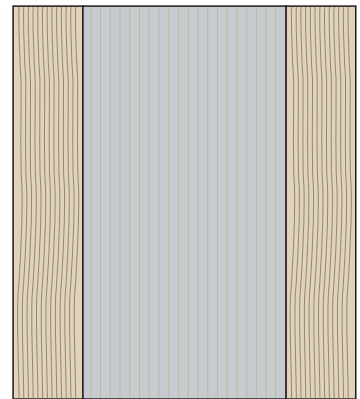
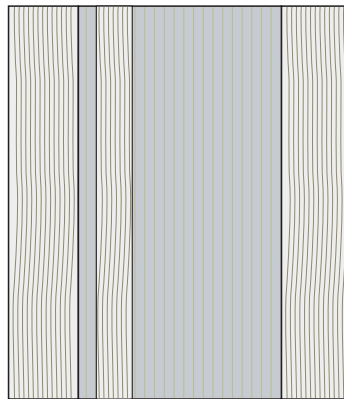
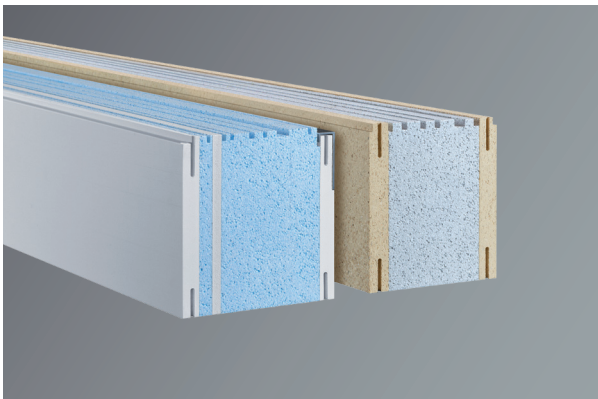

### Range and design

| Type                    | Cover panel and surface                                   | Thermal insulation  | U-values   |
|-------------------------|---|---|--|
| PVC, white              | Both sides 19 mm<br>Integral foam board made of rigid PVC | Intensely expanded polystyrene rigid foam (EPS perimeter), 30 kg/m <sup>3</sup> | Thermal transmittance coefficients up to 0.1 W/m <sup>2</sup> K<br><br>(For U-values, see table on technical data sheet) |
| Polyurethane, untreated | Both sides 26 mm<br>Polyurethane board                    |   |  |

### Thicknesses

Thicknesses from 100 to 240 mm can be produced.

For thicknesses below 100 mm, see substructure elements for plastic balcony doors.

### Formats

Integral foam board: 500 × 95 mm to 2988 × 1294 mm

Polyurethane board: 500 × 95 mm to 3588 × 1294 mm

Substructure elements that are longer than 2988 or 3588 mm are shaped with grooves for dovetail joints.

### Edge milling

All possible edge profile work is performed according to your threshold profile.

### Consultation

For more information please refer to the technical data sheets. Our technical consultants are at your service for all questions.

### Frinorm AG, Wärmedämmelemente

Föhrenweg 12, FL-9496 Balzers, phone 00423 384 23 66, fax 00423 384 23 35, [www.frinorm.com](http://www.frinorm.com), [info@frinorm.com](mailto:info@frinorm.com)