

Type SPK thermal insulation boards

Application

The Frinorm type SPK thermal insulation board is suited for installation on wooden structures on ceilings and walls in new and converted buildings as well as in old-building renovation. It is suited for agricultural, commercial, industrial and public buildings. Thanks to its washable, pore-free and easy to care for surface, the thermal insulation board can also be used in rooms with high hygiene requirements.

Properties

- Outstanding thermal insulation values of up to 0.42 W/m²K
- Surface coated with white plastic foil
- White plastic H-profile rail for covering the board joints
- Washable, pore-free and non-exuding
- Protection from mice and insects
- Dimensionally stable and non-warping
- No thermal bridges, perfect board joints
- Light-coloured, appealing bottom view
- Large board format
- Lightweight
- Uncomplicated and fast installation

Product description

The Frinorm type SPK thermal insulation board has very good thermal insulation properties. Expanded rigid polystyrene foam (EPS), 15 kg/m³, is covered on both sides with thin chipboard E1 P5, 3.5 mm. The visible side is coated with a washable, pore-free and non-exuding plastic foil. One of the long edges is reinforced with a massive wood edge band, which makes the board especially stable. The circumferential groove and tongue joint, covered with a white plastic H-profile rail, ensures joints without thermal bridges. It is installed on a wooden structure, and the boards are attached invisibly in the groove with screws or nails. The large-sized elements ensure fast installation, and processing on site with standard woodworking machines is uncomplicated. The invisible screw connection, the white surface and the board joints covered with H-profile rails give the finished walls a light-coloured and appealing appearance.

Materials

Cover panel (inside): thin chipboard E1 P5, coated with white plastic foil, 3.5 mm

Cover panel (outside): thin chipboard E1 P5, untreated, 3.5 mm

Thermal insulation: expanded rigid polystyrene foam (EPS), 15 kg/m³, 60–80 mm

Edge band: massive wood, on one side

Bonding: water-resistant D3 (EN 204-D3)

Surface: white plastic foil, washable, pore-free and easy to care for

Accessories: white plastic H-profile rail

Edge milling

- Circumferential groove and tongue joint
- Circumferential groove for the plastic H-profile rail

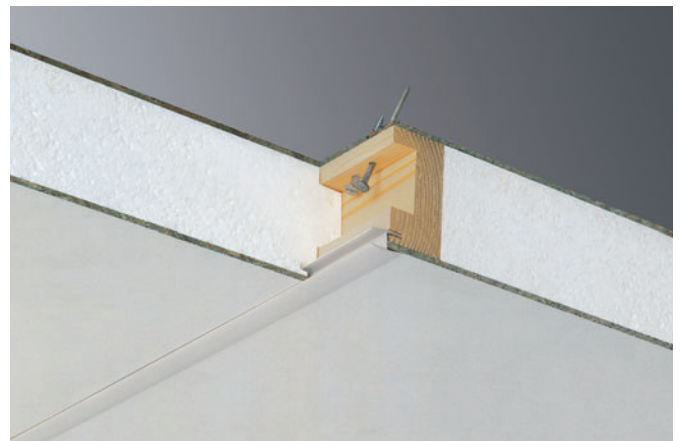
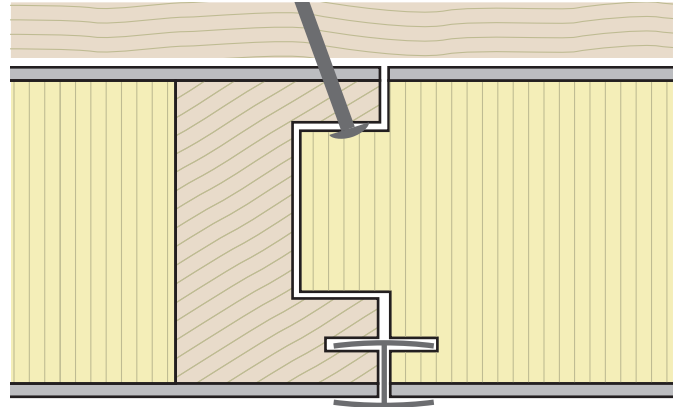

Dimensions

Format: 2480×600 mm (1.488 m²)

Thicknesses: 67, 87 mm

Thermal transmittance coefficients (U-values)

Element thickness	mm	67	87
U-value	W/m ² K	0.553	0.429

Delivery

Delivery of exact quantity on single-use pallets wrapped with stretch film

Consultation

For more information please refer to the technical data sheets. Our technical consultants are at your service for all questions.

