

Ventilation flaps for wooden and wood-metal windows

Sound insulation

Product description

The Frinorm sound insulation ventilation flaps fulfil the requirements of climate categories 3c, 3d and 3e, and reach thermal insulation values of up to 0.3 W/m²K and airborne sound insulation values of up to 41 dB. They are available with a plywood panel AW100, untreated, with primer foil or real wood veneer in all types of wood, or with a rockpanel board. Depending on the sound insulation requirements, the ventilation flaps are fabricated with one or two layers of heavy bitumen foil. PUR rigid foam, 32 kg/m³, is used for thermal insulation. The ventilation flaps are fabricated with a circumferential finger-jointed laminated wooden edge band. Special edge bands can be inset according to your requirements. Preassembled.

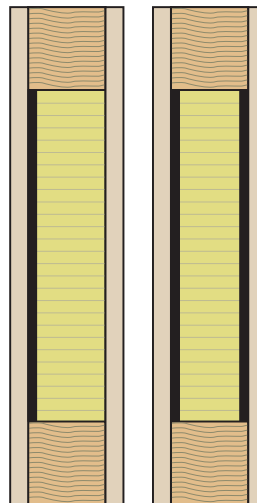

Range and design

Type	Cover panel and surface	Thermal insulation	Edge band	U-values	dB-values	Climate categories
Untreated	Both sides 6.5 mm, plywood panel AW100, untreated	PUR rigid foam 32 kg/m ³ 1 or 2 pieces of heavy bitumen foil	Finger-jointed laminated spruce pine	Thermal transmittance coefficients up to 0.3 W/m ² K (For U-values, see table on technical data sheet)	Airborne sound insulation values up to 41 dB (For dB-values, see table on technical data sheet or on download of test reports)	Categories 2c, 2d, 2e (Climate influences based on EN 12219:1999-11)
Primer foil	Both sides 6.5 mm, plywood panel AW100, coated with white primer foil		For veneered ventilation flaps, the type of wood for the veneer surface is adjusted (Special edge bands are inset according to your requirements)			
Veneered	Both sides 6.5 mm, plywood panel AW100, covered with 1 mm real wood veneer; all types of real wood veneers available: spruce pine, pine, larch, fir, oak, etc.; veneer quality A/B (inside A/outside B) or A/A (inside A/outside A)					
Rockpanel	Rockpanel board 8 mm, with primer					

Thicknesses

Thicknesses from 40 to 112 mm can be produced.

Formats

Plywood: 500 × 200 to 2988 × 1294 mm

Rockpanel: 500 × 200 to 3038 × 1194 mm

CNC edge milling

Preassembled

Consultation

For more information please refer to the technical data sheets.

Our technical consultants are at your service for all questions.