

## Frame extension elements for plastic lifting sliding doors

### Sound insulation

#### Product description

The Frinorm frame extension elements for plastic lifting sliding doors are especially suited for meeting high thermal insulation requirements. They are available in hard PVC, 4 mm, in different shades of white (Veka, Kömmerling, Finstral or Internorm) or HPL with decorative foil, 4 mm (all colours). Depending on the sound insulation requirements, the frame extension elements are fabricated with heavy bitumen foil. Glass wool, 70 kg/m<sup>3</sup>, is used for thermal insulation. The frame extension elements are fabricated with a circumferential plywood edge band. Special edge bands are inset according to your requirements. All possible CNC edge profile work is performed on all sides according to your profile specifications. Special CNC processing like cut-outs, ventilation slots or surface grooves are also possible.

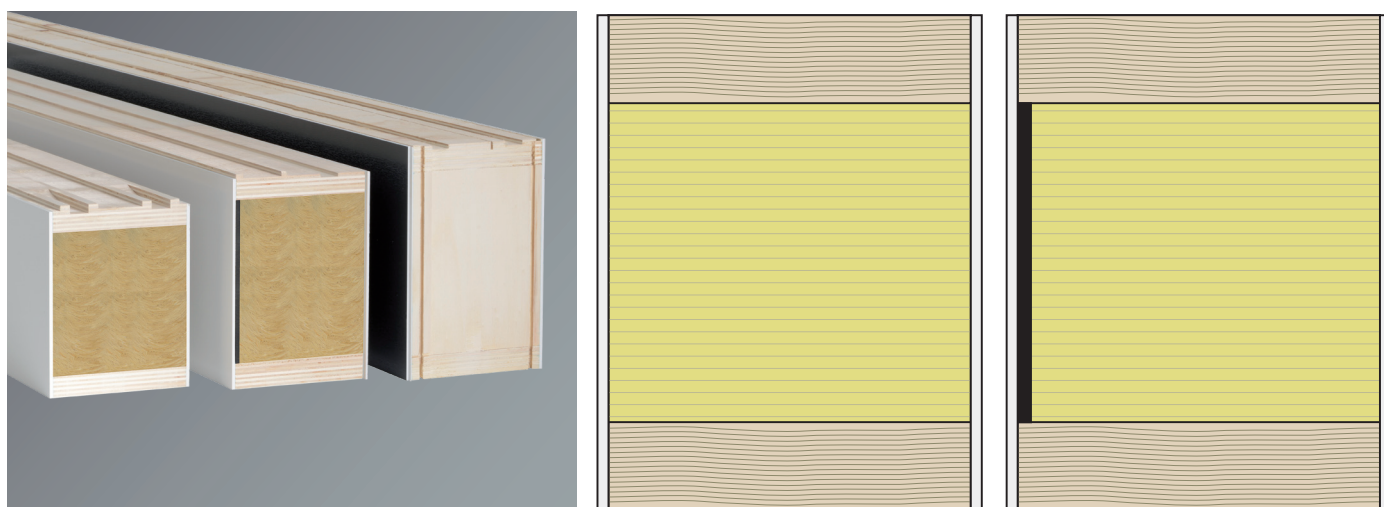

#### Range and design

Type	Cover panel and surface	Thermal and sound insulation	Edge band	U-values	dB-values
<b>PVC, white</b>	Both sides 4 mm, hard PVC, colour: Veka, Kömmerling, Finstral or Internorm	Glass wool, 70 kg/m <sup>3</sup>  <b>Sound insulation 1:</b> without heavy bitumen foil	Plywood IW67, circumferential  (Special edge bands are inset according to your requirements)	Thermal transmittance coefficients up to 0.1 W/m <sup>2</sup> K  (For U-values, see table on technical data sheet)	Airborne sound insulation values of up to 46 dB  (For dB-values, see table on technical data sheet or on download of test reports)
<b>HPL, decorative foil</b>	Both sides 4 mm, HPL, coated with decorative foil; all colours available	<b>Sound insulation 2:</b> 1 piece of heavy bitumen foil			

#### Thicknesses

Thicknesses from 113 to 220 mm can be produced.

For thicknesses below 113 mm, see window frame extension elements for plastic windows.

#### Formats

Hard PVC, white: all formats from 500 × 95 mm up to 3588 × 1294 mm can be manufactured.

HPL, decorative foil: all formats from 500 × 95 mm up to 2988 × 1294 mm can be manufactured.

**CNC edge milling**

All possible CNC edge profile work is performed on all sides according to your profile specifications. Special CNC processing like cut-outs, ventilation slots or surface grooves are also possible.

**Consultation**

For more information please refer to the technical data sheets.  
Our technical consultants are at your service for all questions.