

## Ventilation flaps for wooden and wood-metal windows Standard

### Product description

The Frinorm standard ventilation flaps fulfil the requirements of climate categories 3c, 3d and 3e, and reach thermal insulation values of up to 0.2 W/m<sup>2</sup>K and airborne sound insulation values of up to 34 dB. They are available with a plywood panel AW100, untreated, with primer foil or real wood veneer in all types of wood, or with a rockpanel board. PUR rigid foam, 32 kg/m<sup>3</sup>, is used for thermal insulation. The ventilation flaps are fabricated with a circumferential finger-jointed laminated wooden edge band. Special edge bands can be inset according to your requirements. Preassembled.

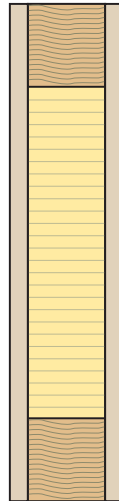

### Range and design

| Type               | Cover panel and surface   | Thermal insulation                   | Edge band   | U-values   | dB-values   | Climate categories  |
|--------------------|---|--------------------------------------|---|--|---|---|
| <b>Untreated</b>   | Both sides 6.5 mm, plywood panel AW100, untreated   | PUR rigid foam, 32 kg/m <sup>3</sup> | Finger-jointed laminated spruce pine  | Thermal transmittance coefficients up to 0.2 W/m <sup>2</sup> K<br><br>(For U-values, see table on technical data sheet) | Airborne sound insulation values up to 34 dB<br><br>(For dB-values, see table on technical data sheet or on download of test reports) | Categories 3c, 3d, 3e<br><br>(Climate influences based on EN 12219:1999-11) |
| <b>Primer foil</b> | Both sides 8 mm, plywood panel AW100, coated with white primer foil   |                                      | For veneered ventilation flaps, the type of wood for the veneer surface is adjusted |  |   |   |
| <b>Veneered</b>    | Both sides 6.5 mm, plywood panel AW100, covered with 1 mm real wood veneer; all types of real wood veneers available:<br>spruce pine, pine, larch, fir, oak, etc.;<br>veneer quality A/B (inside A/outside B) or A/A (inside A/outside A) |                                      | (Special edge bands are inset according to your requirements)                       |  |   |   |
| <b>Rockpanel</b>   | Rockpanel board 8 mm, with primer   |                                      |   |  |   |   |

**Thicknesses**

Thicknesses from 40 to 112 mm can be produced.

**Formats**

Plywood: 500 × 200 to 2988 × 1294 mm

Rockpanel: 500 × 200 to 3038 × 1194 mm

**CNC edge milling**

Preassembled

**Consultation**

For more information please refer to the technical data sheets.

Our technical consultants are at your service for all questions.