

Frame extension elements for wooden and wood-metal lifting sliding doors
Sound insulation

Product description

The Frinorm sound insulation frame extension elements for wooden and wood-metal lifting sliding doors are especially suited for high demands on sound insulation as well as high thermal insulation requirements. They are available with chipboard P5, E1, either untreated, covered with primer foil or with a real wood veneer in all types of wood, Biofaser Hydropan hardboard either untreated or with a real wood veneer, or medium-density fibreboard (MDF) P3, E1. Depending on the sound insulation requirements, the frame extension elements are fabricated with glass wool thermal insulation 20 kg/m³ or with glass wool thermal insulation 20 kg/m³ and heavy bitumen foil. The frame extension elements are fabricated with a circumferential plywood edge band. Special edge bands can be inset according to your requirements. All possible CNC edge profile work is performed on all sides according to your profile specifications. Special CNC processing like cut-outs, ventilation slots or surface grooves are also possible.

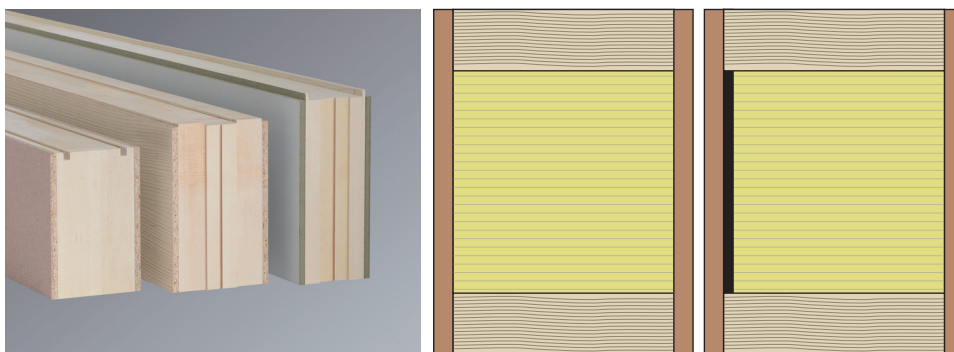

Range and design

Type	Cover panel and surface	Thermal insulation	Edge band	U-values	dB-values
Untreated	Both sides 10 mm, chipboard P5, E1, untreated	Sound insulation 1: glass wool, 20 kg/m ³ Sound insulation 2: glass wool, 20 kg/m ³ 1 piece of heavy bitumen foil	Plywood IW67, circumferential (Special edge bands are inset according to your requirements)	Thermal transmittance coefficients up to 0.1 W/m ² K (For U-values, see table on technical data sheet)	Airborne sound insulation values up to 46 dB (For dB-values, see table on technical data sheet or on download of test reports)
	Both sides 8 mm, Biofaser BF-STX, untreated				
Primer foil	Both sides 10 mm, chipboard P5, E1, coated with white primer foil				
	Both sides 10 mm, medium-density fibreboard (MDF) P3, E1, coated with white primer foil				
Veneered	Both sides 10 mm, chipboard P5, E1, covered with 1 mm real wood veneer (unsanded); all types of real wood veneers available: spruce, pine, larch, fir, oak, etc.; veneer quality A/B (inside A/outside B) or A/A (inside A/outside A)				
	Both sides 8 mm, Biofaser BF-STX, covered with 1 mm real wood veneer (unsanded); all types of real wood veneers available: spruce, pine, larch, fir, oak, etc.; veneer quality A/B (inside A/outside B) or A/A (inside A/outside A)				

Thicknesses

Thicknesses from 100 mm to 220 mm can be produced.

For thicknesses below 100 mm, see frame extension elements for wooden and wood-metal windows.

Formats

All formats from 500 × 95 mm to 3588 × 1294 mm can be produced.

CNC edge milling

All possible CNC edge profile work is performed on all sides according to your profile specifications. Special CNC processing like cut-outs, ventilation slots or surface grooves are also possible.

Consultation

For more information please refer to the technical data sheets.

Our technical consultants are at your service for all questions.